

SAREDON CP



SAFETY, HEALTH AND ENVIRONMENTAL INFORMATION BOX

IT IS ASSUMED THAT ALL WORKS ON THIS DRAWING WILL BE CARRIED OUT BY A COMPETENT CONTRACTOR WORKING WHERE APPROPRIATE, TO AN APPROPRIATE METHOD STATEMENT.

THIS DRAWING IS TO BE USED ONLY FOR THE PURPOSE OF ISSUE THAT IT WAS ISSUED FOR AND IS SUBJECT TO AMENDMENT.

EXCEPTIONAL RISKS RELATING TO THE WORKS ASSOCIATED WITH THIS DRAWING ARE IDENTIFIED BELOW.

CONSTRUCTION

MAINTENANCE / OPERATION / DECOMMISSIONING / DEMOLITION

NOTES

1. THIS DRAWING IS TO BE READ IN CONJUNCTION WITH ALL OTHER RELEVANT DOCUMENTATION.
2. DO NOT SCALE FROM THIS DRAWING, USE ONLY PRINTED DIMENSIONS.
3. ALL DIMENSIONS IN MILLIMETRES, ALL CHAINAGES, LEVELS AND COORDINATES ARE IN METRES UNLESS DEFINED OTHERWISE.

© Crown copyright and database rights 2019
Ordnance Survey 100030649

Revised Template	EC	AR	11/11/19	P03
Area of limited access added to the plan	EC	AR	24/09/19	P02
First Issue	EC	AR	24/06/19	P01
Revision Details	By	Check	Date	Suffix

Purpose of issue
DCO APPLICATION

Client
Highways England
The Cube
199 Wharfside Street
Birmingham
B1 1RN

Working on behalf of
highways england

Development Consent Order Number
TR010054

Project Title
M54 TO M6 LINK ROAD

Drawing Title
**FIGURE 8.30:
REPTILE BASELINE
MAT LOCATIONS
PAGE 1 OF 3**

Designed EC	Drawn EC	Checked AR	Approved TP	Date 11/11/2019
----------------	-------------	---------------	----------------	--------------------

Internal Project No.
60536736

Suitability
S8

Scale @ A3
1:4,500

Zone
M54 to M6 Link Road

THIS DOCUMENT HAS BEEN PREPARED PURSUANT TO AND SUBJECT TO THE TERMS OF AECOM'S APPOINTMENT BY ITS CLIENT. AECOM ACCEPTS NO LIABILITY FOR ANY USE OF THIS DOCUMENT OTHER THAN BY ITS ORIGINAL CLIENT OR FOLLOWING AECOM'S EXPRESS AGREEMENT TO SUCH USE, AND ONLY FOR THE PURPOSES FOR WHICH IT WAS PREPARED AND PROVIDED.

Drawing Number HE514465	Originator -ACM	Volume -EGN	Rev P03
M54_SW_PR_Z	-DR	-EG -0035	
Location	Type	Role	Number

- LEGEND**
- Scheme Boundary
 - Area 3 Reptile Mat Locations with Access Limitations (2019)
 - Area A Reptile Mat Locations (2018) - 10 Artificial Refugia
 - Area B Reptile Mat Locations (2018) - 10 Artificial Refugia
 - Area C Reptile Mat Locations (2018) - 10 Artificial Refugia
 - Area D Reptile Mat Locations (2018) - 5 Artificial Refugia
 - Area E Reptile Mat Locations (2018) - 5 Artificial Refugia
 - Area F Reptile Mat Locations (2018) - 14 Artificial Refugia
 - Area G Reptile Mat Locations (2018) - 14 Artificial Refugia
 - Area 1A Reptile Mat Location (2019)
 - Area 1B Reptile Mat Location (2019)
 - Area 1C Reptile Mat Location (2019)
 - Area 2 Reptile Mat Location (2019)
 - Area 3 Reptile Mat Location (2019)
 - Area 4 Reptile Mat Location (2019)

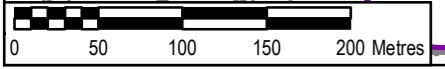
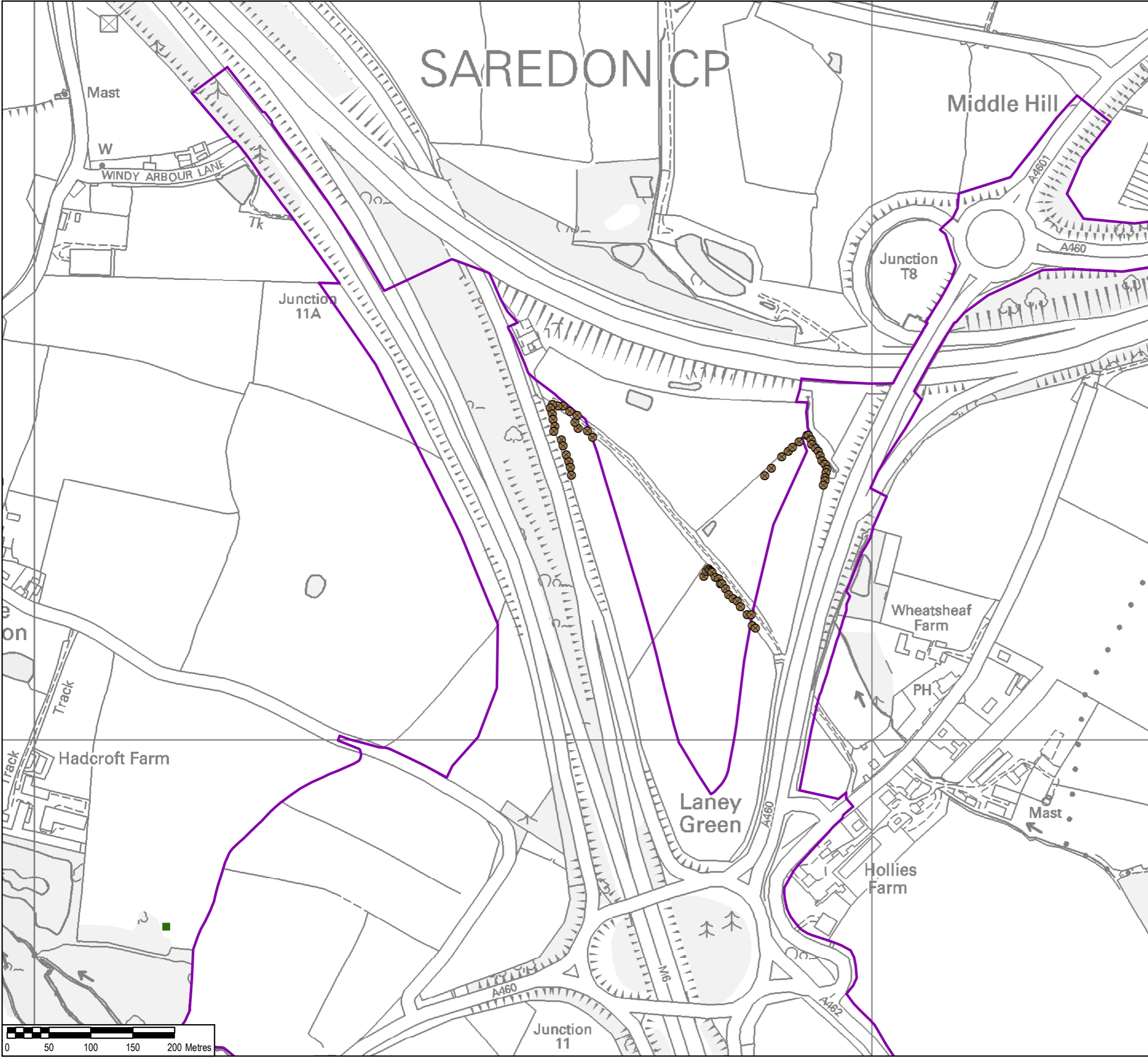

Plot Date: 11 November 2019 09:47:04
 File Name: \\ukas2pfs001\ukas2pfs001\1\1\1\ENVIRONMENT\Practice Areas\GIS\Projects\M54\M6 Link\Workspace\Stage 3 Figures\Ecology\PO2 Template\HE514465-ACM-EGN-M54_SW_PR_Z-DR-EG-0035 - Reptile Mat Locations 2019 Survey.mxd

Plot Date: 11 November 2019 09:47:04
 File Name: \\ukas2pfs001\1\1\1\ENVIRONMENT\Practice Areas\GIS\Projects\M54\M6 Link\Workspace\Stage 3 Figures\Ecology\PO2 Template\HE514465-ACM-EGN-M54_SW_PR_Z-DR-EG-0035 - Reptile Mat Locations 2019 Survey.mxd

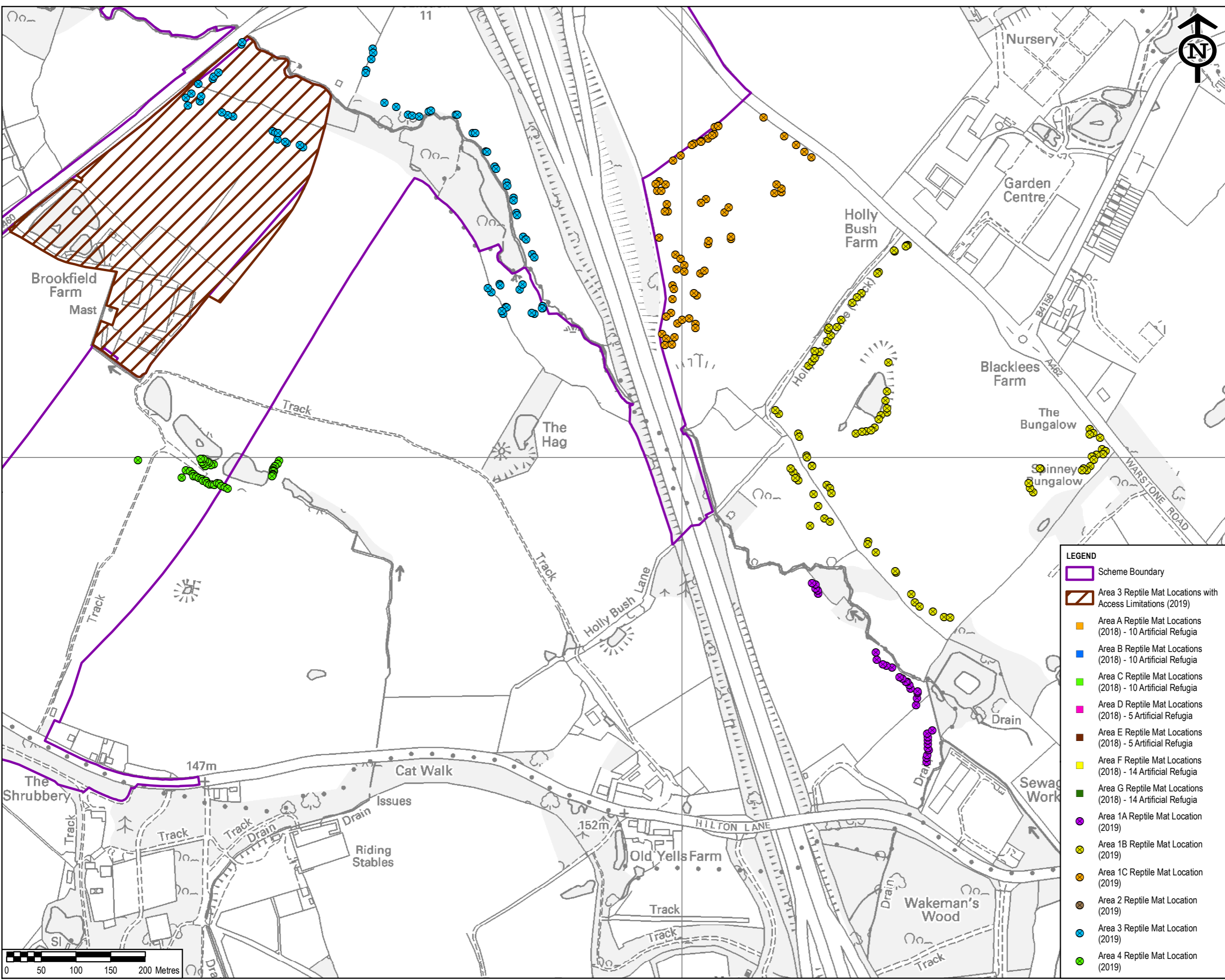

SAFETY, HEALTH AND ENVIRONMENTAL INFORMATION BOX

IT IS ASSUMED THAT ALL WORKS ON THIS DRAWING WILL BE CARRIED OUT BY A COMPETENT CONTRACTOR WORKING, WHERE APPROPRIATE, TO AN APPROPRIATE METHOD STATEMENT.

THIS DRAWING IS TO BE USED ONLY FOR THE PURPOSE OF ISSUE THAT IT WAS ISSUED FOR AND IS SUBJECT TO AMENDMENT.

EXCEPTIONAL RISKS RELATING TO THE WORKS ASSOCIATED WITH THIS DRAWING ARE IDENTIFIED BELOW.

CONSTRUCTION

MAINTENANCE / OPERATION / DECOMMISSIONING / DEMOLITION

NOTES

- THIS DRAWING IS TO BE READ IN CONJUNCTION WITH ALL OTHER RELEVANT DOCUMENTATION.
- DO NOT SCALE FROM THIS DRAWING, USE ONLY PRINTED DIMENSIONS.
- ALL DIMENSIONS IN MILLIMETRES, ALL CHAINAGES, LEVELS AND COORDINATES ARE IN METRES UNLESS DEFINED OTHERWISE.

© Crown copyright and database rights 2019
 Ordnance Survey 100030649

Revised Template	EC	AR	11/11/19	P03
Area of limited access added to the plan	EC	AR	24/09/19	P02
First Issue	EC	AR	24/06/19	P01
Revision Details	By	Check	Date	Suffix

Purpose of issue
DCO APPLICATION

Client
 Highways England
 The Cube
 199 Wharfside Street
 Birmingham
 B1 1RN

Working on behalf of

Development Consent Order Number
TR010054

Project Title
M54 TO M6 LINK ROAD

Drawing Title
**FIGURE 8.30:
 REPTILE BASELINE
 MAT LOCATIONS
 PAGE 2 OF 3**

Designed EC	Drawn EC	Checked AR	Approved TP	Date 11/11/2019
----------------	-------------	---------------	----------------	--------------------

Internal Project No.
60536736

Suitability
S8

Scale @ A3
1:5,000

Zone
M54 to M6 Link Road

THIS DOCUMENT HAS BEEN PREPARED PURSUANT TO AND SUBJECT TO THE TERMS OF AECOM'S APPOINTMENT BY ITS CLIENT. AECOM ACCEPTS NO LIABILITY FOR ANY USE OF THIS DOCUMENT OTHER THAN BY ITS ORIGINAL CLIENT OR FOLLOWING AECOM'S EXPRESS AGREEMENT TO SUCH USE, AND ONLY FOR THE PURPOSES FOR WHICH IT WAS PREPARED AND PROVIDED.

Drawing Number HE514465	Originator -ACM	Volume -EGN	Rev P03
M54_SW_PR_Z	-DR-EG-0035		
Location	Type Role Number		

- LEGEND**
- Scheme Boundary
 - Area 3 Reptile Mat Locations with Access Limitations (2019)
 - Area A Reptile Mat Locations (2018) - 10 Artificial Refugia
 - Area B Reptile Mat Locations (2018) - 10 Artificial Refugia
 - Area C Reptile Mat Locations (2018) - 10 Artificial Refugia
 - Area D Reptile Mat Locations (2018) - 5 Artificial Refugia
 - Area E Reptile Mat Locations (2018) - 5 Artificial Refugia
 - Area F Reptile Mat Locations (2018) - 14 Artificial Refugia
 - Area G Reptile Mat Locations (2018) - 14 Artificial Refugia
 - Area 1A Reptile Mat Location (2019)
 - Area 1B Reptile Mat Location (2019)
 - Area 1C Reptile Mat Location (2019)
 - Area 2 Reptile Mat Location (2019)
 - Area 3 Reptile Mat Location (2019)
 - Area 4 Reptile Mat Location (2019)

Plot Date: 11 November 2019 09:47:04
 File Name: \\ukg3pfs001\1\1\1\ENVIRONMENT\Practice Areas\GIS\Projects\M54\M6 Link\Workspace\Stage 3 Figures\Ecology\PO2 Template\HE514465-ACM-EGN-M54_SW_PR_Z-DR-EG-0035 - Reptile Mat Locations 2019 Survey.mxd

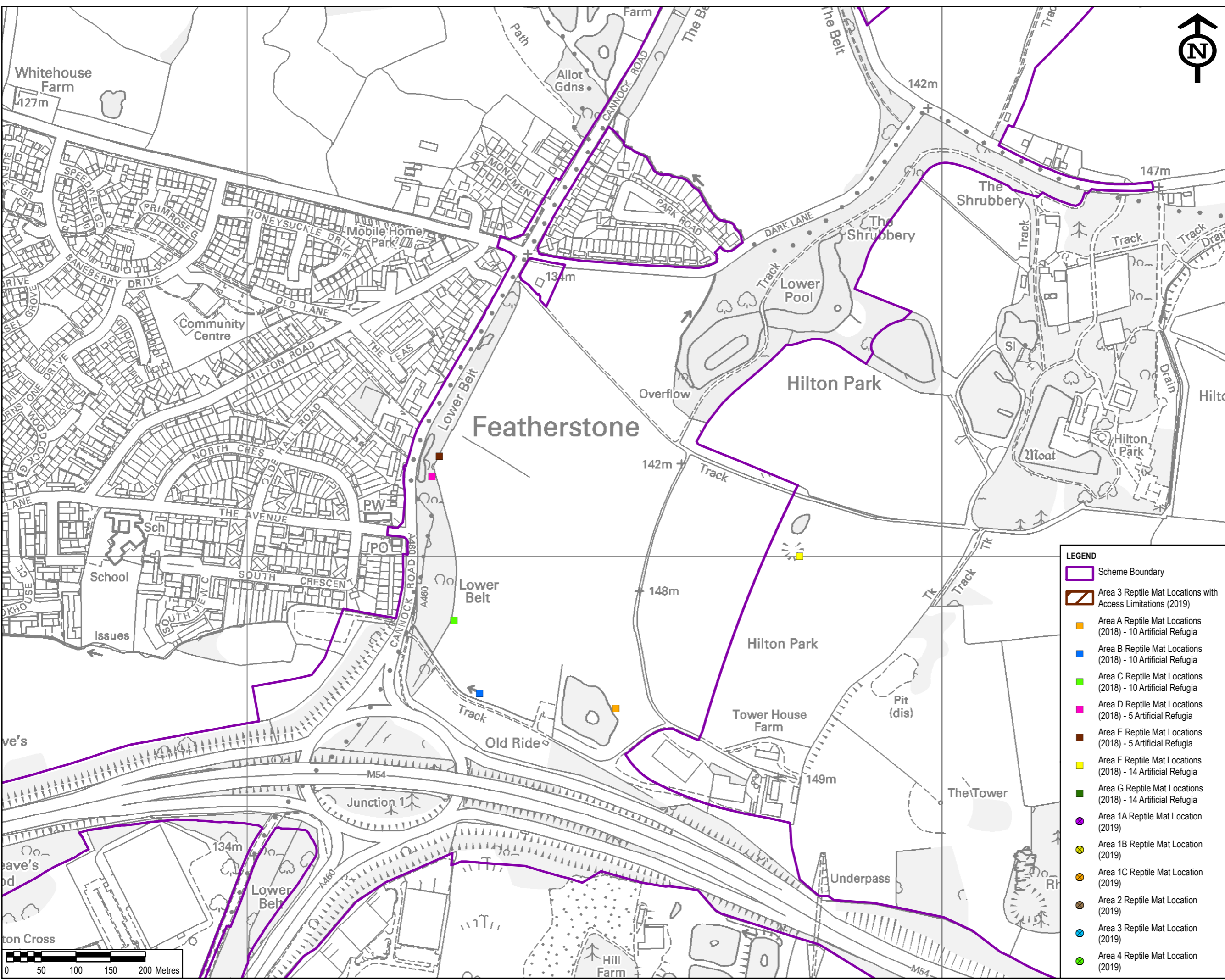

SAFETY, HEALTH AND ENVIRONMENTAL INFORMATION BOX

IT IS ASSUMED THAT ALL WORKS ON THIS DRAWING WILL BE CARRIED OUT BY A COMPETENT CONTRACTOR WORKING WHERE APPROPRIATE, TO AN APPROPRIATE METHOD STATEMENT.

THIS DRAWING IS TO BE USED ONLY FOR THE PURPOSE OF ISSUE THAT IT WAS ISSUED FOR AND IS SUBJECT TO AMENDMENT.

EXCEPTIONAL RISKS RELATING TO THE WORKS ASSOCIATED WITH THIS DRAWING ARE IDENTIFIED BELOW.

CONSTRUCTION

MAINTENANCE / OPERATION / DECOMMISSIONING / DEMOLITION

NOTES

- THIS DRAWING IS TO BE READ IN CONJUNCTION WITH ALL OTHER RELEVANT DOCUMENTATION.
- DO NOT SCALE FROM THIS DRAWING, USE ONLY PRINTED DIMENSIONS.
- ALL DIMENSIONS IN MILLIMETRES, ALL CHAINAGES, LEVELS AND COORDINATES ARE IN METRES UNLESS DEFINED OTHERWISE.

© Crown copyright and database rights 2019
 Ordnance Survey 100030649

Revised Template	EC	AR	11/11/19	P03
Area of limited access added to the plan	EC	AR	24/09/19	P02
First Issue	EC	AR	24/06/19	P01
Revision Details	By	Check	Date	Suffix

Purpose of issue
DCO APPLICATION

Client
 Highways England
 The Cube
 199 Wharfedale Street
 Birmingham
 B1 1RN

Working on behalf of

Development Consent Order Number
TR010054

Project Title
M54 TO M6 LINK ROAD

Drawing Title
**FIGURE 8.30:
 REPTILE BASELINE
 MAT LOCATIONS
 PAGE 3 OF 3**

Designed EC	Drawn EC	Checked AR	Approved TP	Date 11/11/2019
----------------	-------------	---------------	----------------	--------------------

Internal Project No.
60536736

Suitability
S8

Scale @ A3
1:5,000

Zone
M54 to M6 Link Road

THIS DOCUMENT HAS BEEN PREPARED PURSUANT TO AND SUBJECT TO THE TERMS OF AECOM'S APPOINTMENT BY ITS CLIENT. AECOM ACCEPTS NO LIABILITY FOR ANY USE OF THIS DOCUMENT OTHER THAN BY ITS ORIGINAL CLIENT OR FOLLOWING AECOM'S EXPRESS AGREEMENT TO SUCH USE, AND ONLY FOR THE PURPOSES FOR WHICH IT WAS PREPARED AND PROVIDED.

Drawing Number HE514465	Originator -ACM	Volume -EGN	Rev P03
M54_SW_PR_Z	-DR	-EG -0035	
Location	Type	Role	Number

- LEGEND**
- Scheme Boundary
 - Area 3 Reptile Mat Locations with Access Limitations (2019)
 - Area A Reptile Mat Locations (2018) - 10 Artificial Refugia
 - Area B Reptile Mat Locations (2018) - 10 Artificial Refugia
 - Area C Reptile Mat Locations (2018) - 10 Artificial Refugia
 - Area D Reptile Mat Locations (2018) - 5 Artificial Refugia
 - Area E Reptile Mat Locations (2018) - 5 Artificial Refugia
 - Area F Reptile Mat Locations (2018) - 14 Artificial Refugia
 - Area G Reptile Mat Locations (2018) - 14 Artificial Refugia
 - Area 1A Reptile Mat Location (2019)
 - Area 1B Reptile Mat Location (2019)
 - Area 1C Reptile Mat Location (2019)
 - Area 2 Reptile Mat Location (2019)
 - Area 3 Reptile Mat Location (2019)
 - Area 4 Reptile Mat Location (2019)